

3040

vacuum breaker for
domestic water systems



altecnic
CALEFFI group

3040 vacuum breaker



Application

The Altecnic DZR (Dezincification Resistant) vacuum breakers are intended for use with water storage cylinders from becoming damaged by a sudden and rapid drop in pressure inside the cylinder.

For example this may happen if the inlet shut off valve is left closed and enough water is drawn off to create a significant drop in internal pressure inside the cylinder.

This loss in internal pressure can lead to the cylinder imploding.

Technical Specification - Materials

Body:	DZR material	BS EN 12165 CW724R
Cartridge:	polymer	PPSU
Spring:	stainless steel	
Seal:		silicone
Badge:	polymer	ABS
Cover:	polymer	PA6G30

Technical Specification - Performance

Max. working pressure (water):	14 bar
Max. working pressure (water vapour):	1 bar
Working temperature range:	0 to 120°C
Opening pressure:	1 kPa
Air intake flow rate:	130 NL/min @ 7kPa

Operating Principle

When pressure is applied under working pressure conditions, the vacuum breaker device remains closed, allowing normal system operation to take place.

When the internal pressure drops it allows air to enter at atmospheric pressure to prevent hazardous situations from arising and the cylinder imploding.

Vacuum breakers should be installed at the top of the tank connection pipe.

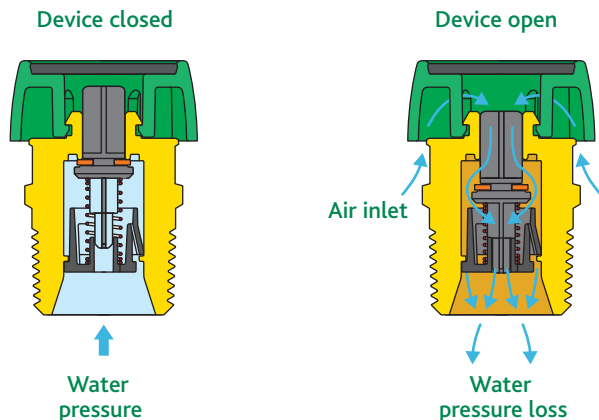

Dimensions

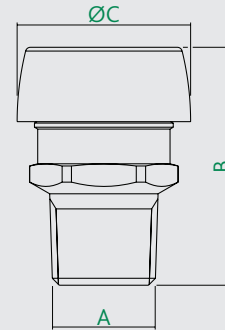

Ref No	A	B	ØC	kg
304040	1/2	40.5	35	0.08
304050	3/4	43.5	35	0.10

Construction Details

Dezincification resistant material with very low lead content (Low Lead)

The material used to make the vacuum breaker valve is perfectly in line with the new regulatory provisions concerning contact with potable water. This is an innovative alloy with a very low lead content and dezincification resistant properties.

Protection from external agents

The shape of the cover means that the valve is protected from dust or other substances which could prevent it from working properly

The vacuum breaker device should nevertheless be installed in a location where it is protected from direct atmospheric agents.

Shaped obturator

The obturator sliding zones are designed to minimise friction and prevent hazardous build-up.

Operating conditions

The material used for the seal is suitable for higher pressures and working temperatures.

3040 vacuum breaker

Installation

Vacuum breakers should be installed in a vertical position, with the cover facing upwards.

For safety reasons, the connecting pipe leading to the vacuum breaker should not contain an isolating valve or similar devices.

Typical Application

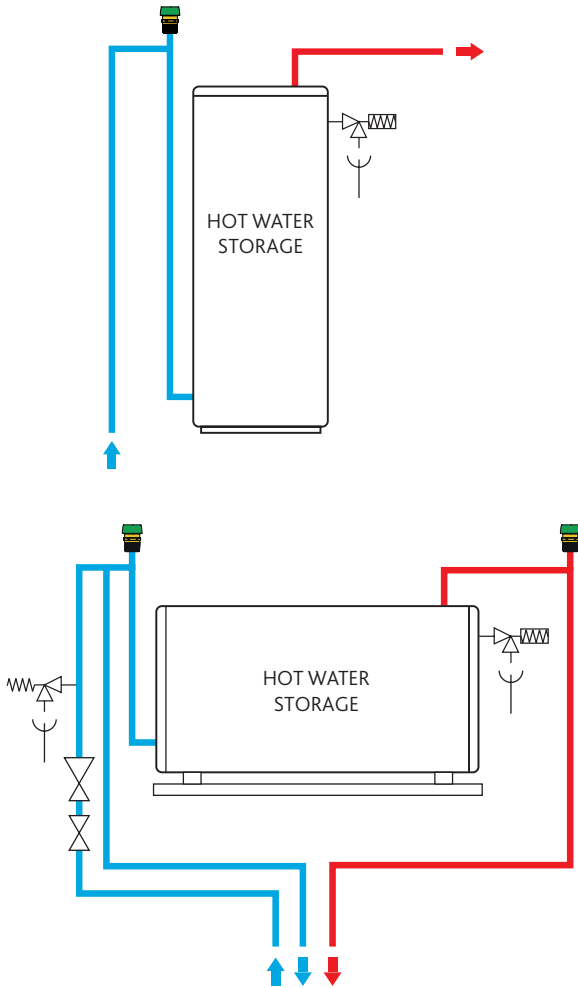

© Patents & Design Altecnic 2023

Altecnic Ltd retains all rights (including patents, designs and copyrights, trademarks and any other intellectual property rights) in relation to all information provided on or via the website, brochures or any other documents, including all texts, graphics and logos, contained on the website, in brochures or in any other documents published in the name of or on behalf of Altecnic Ltd in any form, without prior written consent of Altecnic Ltd.

Altecnic Ltd Mustang Drive, Stafford, Staffordshire ST16 1GW

T: +44 (0)1785 218200 E: sales@altecnic.co.uk

Registered in England No: 02095101

altecnic.co.uk

AL 484 13-06-23

E & O.E

© Altecnic Limited. 2023

ALTECNIC™

altecnic
CALEFFI group